

For more detailed installation, configuration, programming, file transfer, and operating instructions, refer to the touch panel's instruction manual, available on-line at [www.amx.com](http://www.amx.com).



FIG. 1 NXA-BASE/1 Kit (consists of one BASE/1 and a single NXT-BP)

**ATTENTION!**

Verify that the Modero panel is using the latest firmware. Verify that the battery base is loaded with the latest NXA-BASE/1 firmware. These recent builds of firmware incorporate the necessary updates for using the Modero with the NXA-BASE/1.

**Overview of the NXA-BASE/1 Kit**

The NXA-BASE/1 Kit (FG2255-05K) contains one battery and one battery base. The NXA-BASE/1 (FIG. 2) is a Modero accessory that allows an NXT-CV7 touch panel to function off the charge from a single internally connected NXT-BP battery. The base provides both power and battery information to the panel via the panel interface connector. The NXT-BP battery can be charged through either the base (only when connected to the NXT-CV7 touch panel) or through an optional NXT-CHG Modero Power Station. When used with the optional battery base, the CV7 panels will charge the battery during full operation.

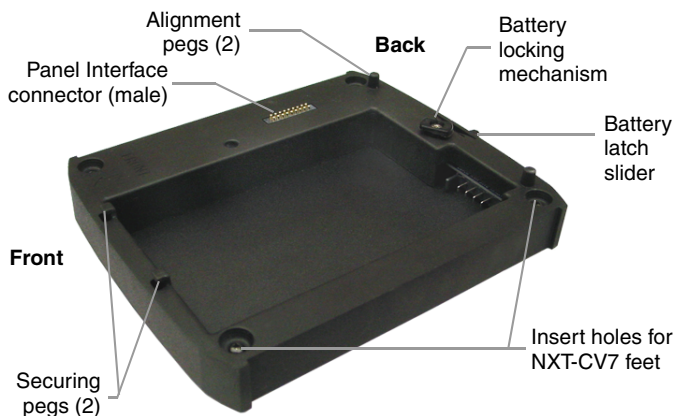

FIG. 2 NXA-BASE/1 showing Panel Interface and connector locations

**Specifications**

NXA-BASE/1 Kit Specifications	
<b>Dimensions (HWD):</b> NXA-BASE/1 (FG2255-05K) NXT-BP (FG2255-10)	<ul style="list-style-type: none"> <li>0.93" x 5.96" x 6.89" (2.36 cm x 15.14 cm x 17.51 cm)</li> <li>0.69" x 3.50" x 5.81" (1.75 cm x 8.89 cm x 14.76 cm)</li> </ul>
<b>Power:</b>	<ul style="list-style-type: none"> <li>NXA-BASE/1: 1.4 A @ 12 VDC (max power draw while charging a single battery)</li> <li>NXT-BP: Voltage - 11.1 Volts (nominal)</li> </ul>
<b>Weight:</b>	<ul style="list-style-type: none"> <li>Base unit: 0.75 lbs (0.34 kg)</li> <li>NXT-BP: 1.0 lbs (0.45 kg)</li> <li>Base and 1 battery: 1.75 lbs (0.79 kg)</li> </ul>
<b>NXA-BASE/1: Features:</b>	<ul style="list-style-type: none"> <li>Charge time for single depleted battery: ~ 5 - 8 hours</li> <li>Must be connected to a Modero unit utilizing a PSN4.4 power supply (or higher)</li> </ul>
<b>NXT-BP Features:</b>	<ul style="list-style-type: none"> <li>Battery Usage: 4 to 8 hours (time is usage dependant)</li> <li>Charge Capacity: 6300mAh</li> </ul>

NXA-BASE/1 Kit Specifications (Cont.)	
<b>Operating / Storage Environment:</b>	<ul style="list-style-type: none"> <li>Operating Temperature: 0° C (32° F) to 40° C (104° F)</li> <li>Operating Humidity: 20% - 85% RH</li> <li>Storage/Discharge Temperature: -20° C (-4° F) to 60° C (140° F)</li> <li>Storage Humidity: 5% - 85% RH</li> </ul>
<b>Included Accessories:</b>	<ul style="list-style-type: none"> <li>N/A</li> </ul>
<b>Optional Accessories:</b>	<ul style="list-style-type: none"> <li>NXT-CHG Kit (FG2250-50K): 1 charger and 2 NXT-BP batteries</li> <li>NXT-BP batteries (FG2255-10) (additional)</li> </ul>

**Checking the NXT-BP Charge**

1. Press the Battery Life Indicator button (FIG. 3) once to illuminate the Battery Life LEDs and display the percent charge remaining on the battery (*this indication lasts a few seconds*).



FIG. 3 NXT-BP Modero Power Pack (showing Battery Life Indicator and button)

2. Charge the NXT-BP battery by either inserting it into the battery base or from within the optional NXT-CHG charger (which can sequentially charge up to two batteries).

**Note:** It is recommended to fully charge this battery before using it to power an NXT-CV7 panel.

**ATTENTION!**

If the 25% LED indicator is blinking, recharge your battery immediately. This blinking indicates there is less than 5% of a charge remaining on the battery.

**Installation of an NXT-BP into the NXA-BASE/1**

The base does not directly connect to a power supply. Instead, it receives the power necessary to charge the battery from the Modero panel (through the Panel Interface connector).

1. Install the NXT-BP battery into the base's battery compartment with the label-side facing up.
2. Align the battery connector with its corresponding battery connector port (located in the battery compartment shown in FIG. 4).

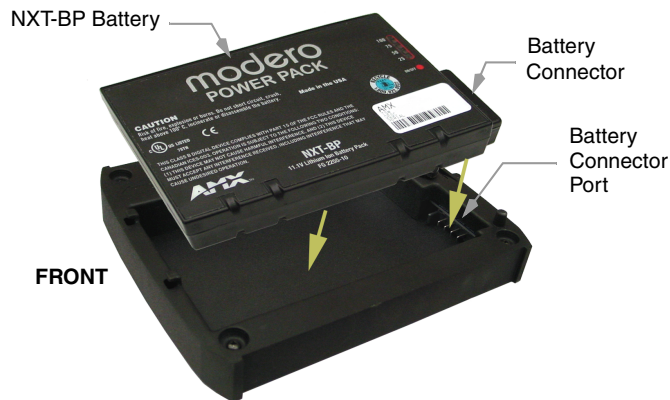

FIG. 4 Battery installation procedure

3. Carefully insert the NXT-BP into the base until the battery securely fits onto the Battery Connector Port.

## Charging the NXT-BP using the NXA-BASE/1

1. Insert the single battery into the battery compartment shown in FIG. 5.
2. Follow the procedures from the previous sub-section to attach the NXT-CV7 to the NXA-BASE/1.
3. Insert a 2-pin connector from a power supply to the rear PWR connector on the NXT-CV7 Modero panel.

## Attaching the NXT-BASE/1 to an NXT Modero Panel

1. Power Off the panel before attempting to attach the NXA-BASE/1.
2. Place the battery base (with battery) onto a flat/level surface.
3. Turn the battery locking slider (FIG. 5) to one side until the locking mechanism is horizontal to the base (going left to right) and the rear battery latch is pointing directly outward (away from the LCD).

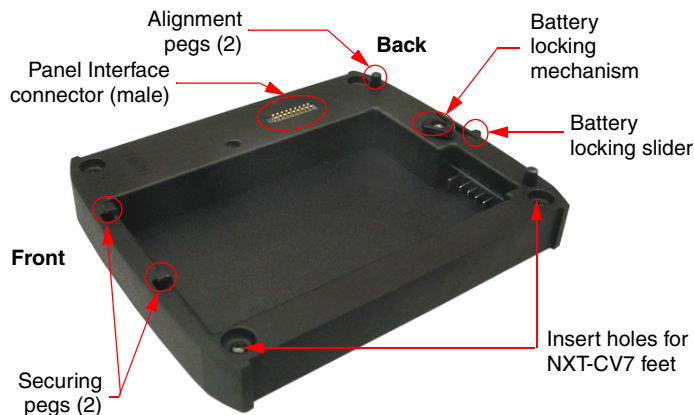

FIG. 5 NXA-BASE/1 showing Panel Interface and connector locations

4. Carefully angle the NXT-CV7 panel over the front alignment pegs (FIG. 6). The pegs assist in both aligning and securing the panel to the base (the locking mechanism secures the base to panel when done).
5. Insert the alignment pegs into their corresponding holes below the front of the panel.
6. Verify the alignment of the Panel Interface connectors between the panel (female connector) and base (male connector) (FIG. 6).
7. Align the rear pegs and gently push the rear of the panel downwards until it is mounted atop the battery base.
8. Slide the rear battery locking slider in the opposite direction. This turns the latching mechanism and secures the panel to the base.

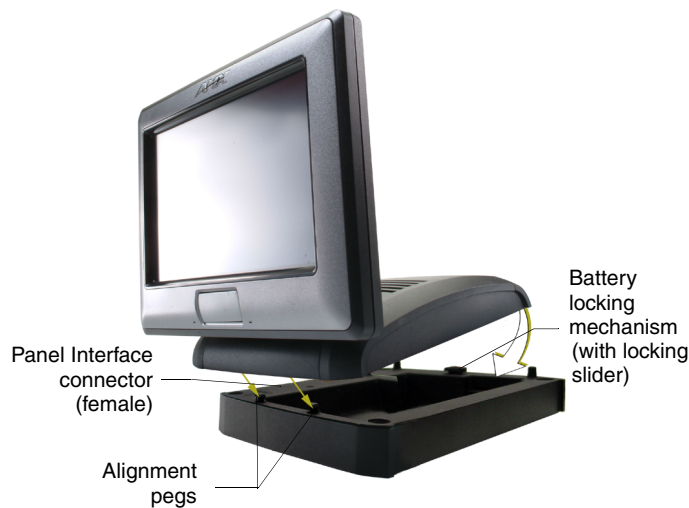

FIG. 6 NXA-BASE/1 shown aligning with an NXT-CV7 panel

### ATTENTION!

The battery base CANNOT be hot-swapped. An NXT can not be receiving power (through a connected power supply) and then be connected to a battery base. Always POWER OFF the panel before installing the NXA-BASE/1.

9. Upon successful connection, the AMX logo appears on the panel to indicate that the panel is properly connected and receiving power.

AMX Corporation reserves the right to alter specifications without notice at any time.  
For full warranty information, refer to the AMX Instruction Manual(s) associated with your Product(s).

036-004-2744 4/06 ©2006

AMX Corporation. All rights reserved. The AMX logo is a trademark of AMX Corporation.

3000 RESEARCH DRIVE, RICHARDSON, TX 75082 • 800.222.0193 • fax 469.624.7153 • technical support 800.932.6993 • www.amx.com

93-2255-05 REV: C

